

PRODUCT DESCRIPTION

- LED replacement for high wattage HID fixtures from 100W to 200W.
- Consumes up to 80% less energy than conventional HID systems.
- State-of-the-art LED light sources deliver over 145 lumens per watt.
- Lasts 3x longer than metal halide or HPS HID lamps.
- Shatter resistant for reduced risk of injury & breakage.
- Integral driver, eliminates the need for external driver or ballast.
- Environmentally friendly: contains no glass, mercury, or lead.
- Suitable for use in totally enclosed fixtures.

SPECIFICATIONS/FEATURES

- Voltage 100-277V ac not compatible with ballasts
- Warranted 70% light output for 50,000 hours
- Non-dimmable
- Up to 145lm/W
- CRI >80Ra
- Power Factor ≥ 0.9
- Surge protection 4KV
- Flame retardant material
- Operating temperature: -40°F to 140°F (-40°C to 60°C)
- Waterproof design Ip64
- Base Types E27/E26/E40/E39/Ex39
- 5 year limited warranty .

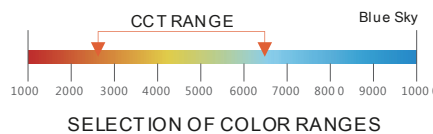

* for approved fixture categories

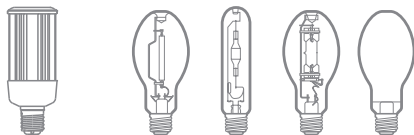

30W	⇒	125W	125W	120W	125W
-----	---	------	------	------	------

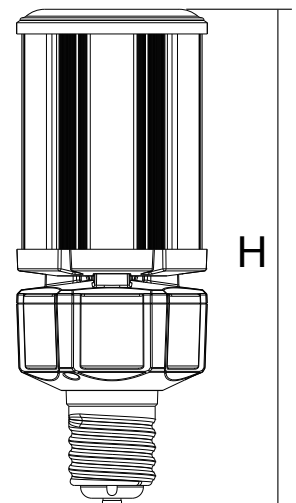
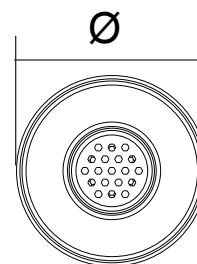
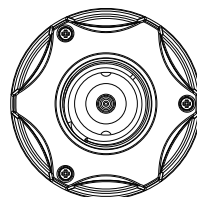

H=E26(205.00mm/8.07")
E39(218.00MM/8.58")
Ø=85mm/3.35"

RETROFIT EXISTING FIXTURES



TECHNICAL SPECIFICATIONS

Model No.	Wattage (W)+/- 5%	AC Input	Lumens +/- 5%	CCT.	PF	THD	Dimensions H*D	Certificate
CLS-FR2G-030-AW-W-03	30	100~227V ac 50/60Hz	4,350	2700-6500K	≥0.9	20%	E26 85*205mm / 3.35"x8.07"	ETL/DLC
							E27 85*208mm / 3.35"x8.19"	
							E39 85*218mm / 3.35"x8.58"	
							E40 85*221mm / 3.35"x8.70"	
							Ex39 85*218mm / 3.35"x8.58"	

* Kelvin Temperatures may vary +/- 250K.

* Line length of Please inquire. Extending the power cord may increase the size of the package.